



**MADE
IN
ITALY**

Installation, use and maintenance

EN

1 GENERAL PRECAUTIONS

Important warnings	In order to protect workers' safety and to avoid the risk of any damage, before performing any operation, please read and become familiar with the contents of the instruction manual.
Symbols used in the manual	<p>In order to signal particularly important instructions or warnings, the following symbols are used:</p> <p>WARNING  This symbol indicates that there is a possibility of damaging the machineries and/or their components.</p> <p>NOTE  This symbol indicates useful information.</p>
Manual storage	This manual must be intact and completely readable. The final users, as well as the qualified technicians authorised to installation and maintenance must be able to view it at any time.
Reproduction rights	<p>All reproduction rights are reserved and belong to Piusi S.p.A The text cannot be used in other printed documents unless expressly authorised in written form by Piusi S.p.A. © Piusi S.p.A. THIS MANUAL BELONGS TO PIUSI S.p.A. WHOLE OR PARTIAL REPRODUCTION OF THIS MANUAL IS FORBIDDEN. Piusi S.p.A. is the exclusive owner of all rights envisaged by applicable laws, including the rules concerning copyrights. All rights arising from these standards are reserved to Piusi S.p.A.: even partial reproduction of this manual, its publication, edit, transcription, communication to the public, distribution, marketing in any form, translation and/or processing, lending, and any other activities are reserved by law to Piusi S.p.A..</p>

2 SAFETY INSTRUCTIONS



The device is powered by a **NON RECHARGEABLE CR2** lithium battery.
Do not try to recharge the batteries!
 Install the batteries observing the correct polarity

3 PRODUCT DESCRIPTION

Manager KEY is a battery-powered memory device designed by PIUSI to download dispensing data from the control units of the Self Service 2018 family dispenser and bring them into the Self Service Management 2018 PC software

	SOFTWARE		SSM 2018
			DATA TRANSFER SSM 2018
	DISPENSERS		CUBE MC
			SELF SERVICE MC
			SELF SERVICE FM
	CONTROL BOX		MCBOX



Package Contents:

- USB Key Manager with CR2 Lithium Battery already mounted
- Type A-Type C 1.5 meter USB cable
- Instruction Manual

4 INSTALLATION

1) Configuration of the Self service Management software

Configure the **Manager Key** as the type of communication on the Self Service Management software

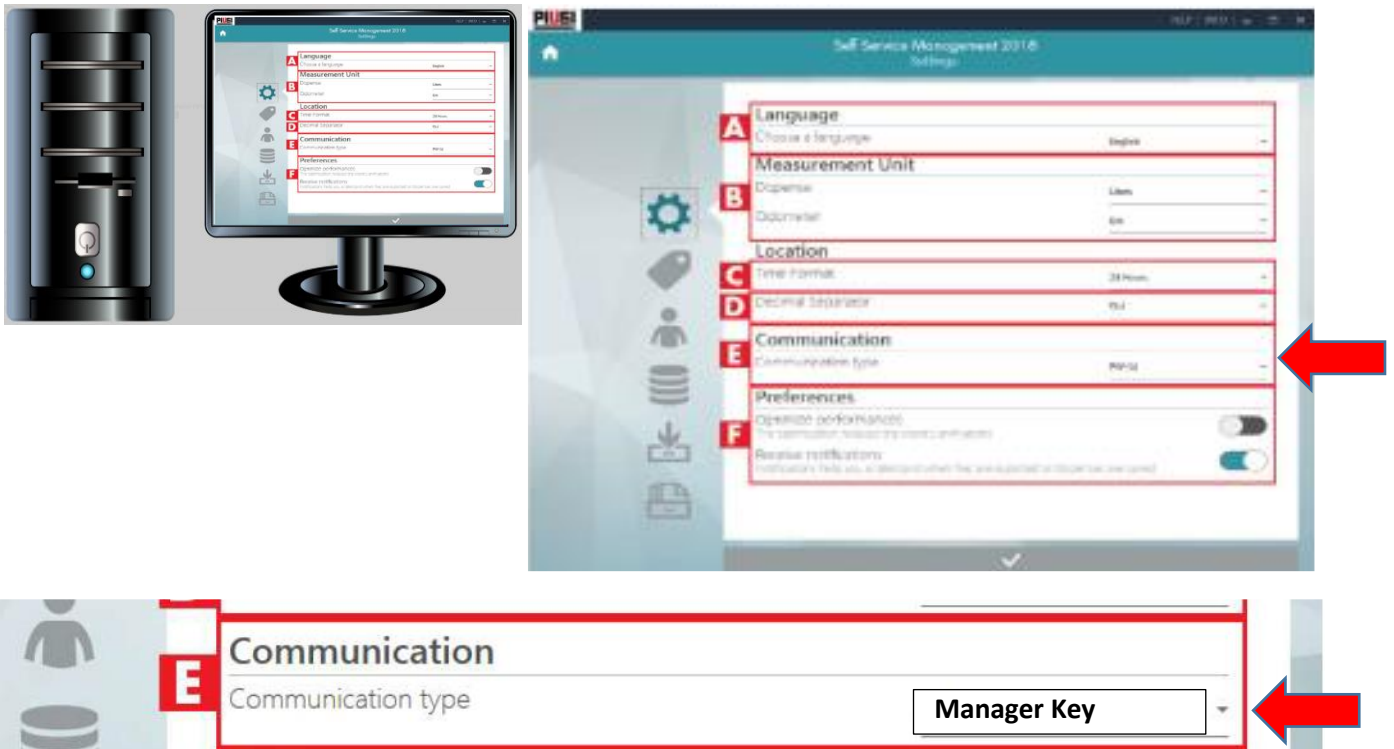

1) Pairing of the Manager Key to the Self Service Dispenser

The vending machine needs to memorize and therefore recognize its Manager Key.

1) Use the PIN CODE MANAGER to enter the System Configuration configuration menu and from here to the advanced configuration menu by pressing the **#** + **1** keys together

a. Check that KEY READER - YES is set in the menus

- b. When the display shows TOUCH MASTER KEY, place the Manager Key on the key reader to pair the Manager Key with the dispenser



5 USO GIORNALIERO

To download dispensers from dispenser and bring them to the Self Service Management Software, proceed with this sequence:

- 1) Press the ON / OFF button  to check the memory and battery status
- a. If the **Battery is charged** the Status Led will show the memory status

 Status LED ON STEADY GREEN means Empty memory and therefore you go to a vending machine to collect the dispensing data

 Status LED ON STEADY RED means memory full. The dispensing data must be downloaded to the software.

- b. If the **Battery is low** the RED Status Led flashes

 Battery to be replaced as soon as possible

If the device is not carrying out any data transfer operation, it turns off:



- automatically after a few seconds,
- or
- you can force shutdown by pressing the ON / OFF button 

- 2) Place the device (whether it has already been switched on or not is indifferent) to the reader on the control unit

- a. Manager Key as soon as it check the contact with the control unit turns on and the control unit enters the menus related to the data download operation

DATA TRANSFER → TOUCH SYSTEM KEY



- b. The data transfer begins and is indicated by the Status Led by a RED and GREEN ALTERNATE flashing 
- c. An indication of the data download is also shown on the display of the electronic control unit
- d. When the transfer is completed (and it is also visible from the display on the vending machine through the DATA TRANSFER OK message) the status LED becomes STEADY RED  to indicate that the memory has been filled.

6 MAINTENANCE

Device maintenance is limited to changing the battery.

If the **battery is low**, after turning on the device  the RED Status Led flashes

 to indicate that the battery needs to be replaced.

To access the battery compartment, follow the instructions as shown in the images
The battery must be a **3 V CR2 type NOT rechargeable lithium battery**

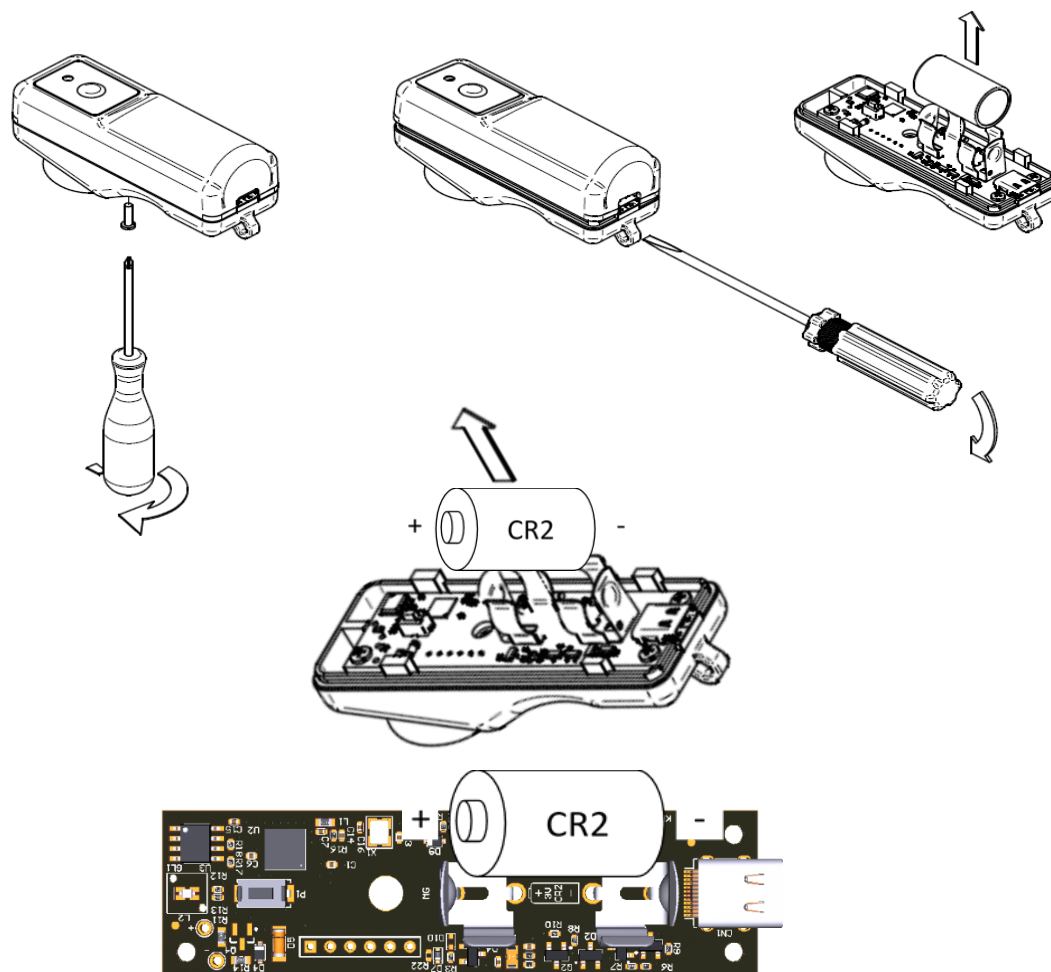

Important notes on battery disposal. By law, it is required not to throw exhausted batteries together with normal household waste as they are highly polluting, but they must be placed in the appropriate containers located in the respective Municipalities to which they belong, whether they are in shops or at landfills. Ask the municipal authorities to find out about the collection sites

7 SCRAPPING AND DISPOSAL

Environmental information for customers in the European Community



European Directive 2012/19/UE requires that the equipment bearing this symbol on the product and/or its packaging must not be disposed of with unsorted municipal waste. The symbol indicates that this product should be disposed of separately from regular household waste streams. It is your responsibility to dispose of this and other electric and electronic equipment via designated collection facilities appointed by the government or local authorities..

In case the system should be demolished, its parts must be given to companies specialised in industrial waste disposal and recycling; in particular:

Disposal of Packaging	Packaging consists of biodegradable cardboard that can be given to firms charged with cellulose recovery.
Disposal of Metal parts	The metal components, both painted and in stainless steel, are usually recycled by companies that are specialised in the metal-scraping industry.
Disposal of electrical and electronic components	<p>Disposing of Waste of Electric and Electronic equipment-WEEE (RAEE for Italy) equipment as household wastes is strictly forbidden. Such wastes must be disposed of separately..</p> <p>These have to be disposed by companies that are specialised in the disposal of electronic components, in accordance with the instructions of 2012/19/UE Any hazardous substances in the electrical and electronic appliances and/or the misuse of such appliances can have potentially serious consequences for the environment and human health..</p> <p>In case of the unlawful disposal of said wastes, fines will be applicable as defined by the laws in force.</p>
Disposal of Other parts	The disposal of other parts such as pipes, rubber seals, plastic components and cables should be entrusted to companies specialized in the disposal of industrial wastes..

- IT Scarica il manuale nella tua lingua!
- EN Download the manual in your language!
- CS Stáhnout příručku ve vašem jazyce!
- DA Download manualen på dit sprog!
- DE Laden Sie das Handbuch in Ihrer Sprache herunter!
- ES ¡Descarga el manual en tu idioma!
- FI Lataa käsikirja omalla kielelläsi!
- FR Téléchargez le manuel dans votre langue!
- NL Download de handleiding in uw taal!
- PL Pobierz instrukcję w swoim języku!
- PT Baixe o manual em seu idioma!
- RU Загрузите руководство на вашем языке

