

DESO

ENGINEERING

Deso Engineering
Slade Way
Roughmoor Industrial Estate
Williton
Somerset
TA4 4TB

Telephone - 01984 632026
Fax - 01984 634267
enquiries@desoengineering.co.uk

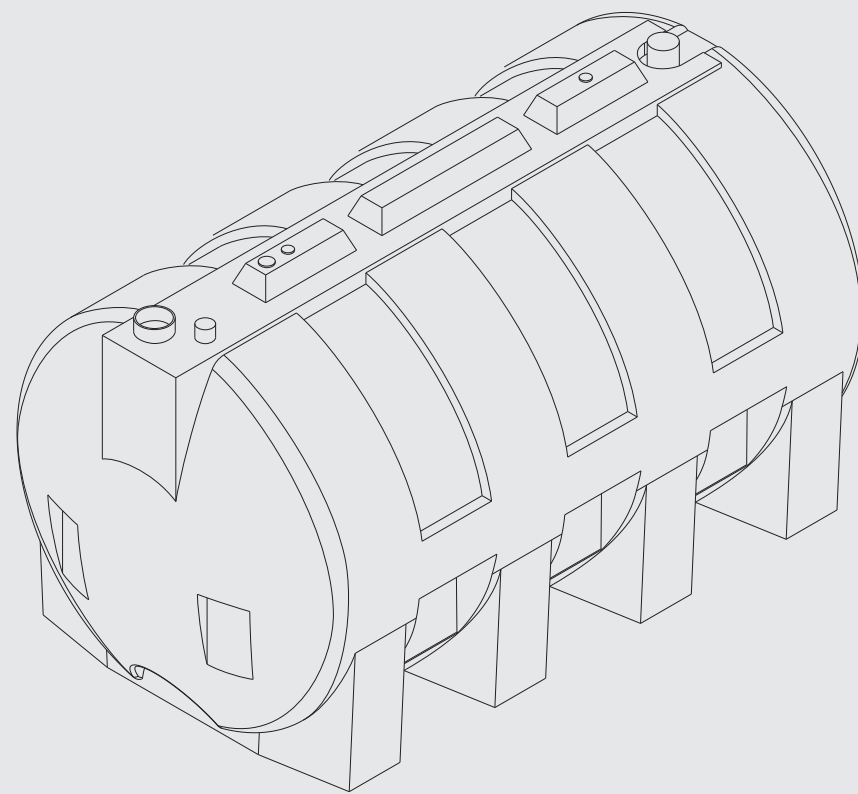

H2500T

Weight	95kg
Capacity	2500litres
Diameter	-
Length	2400mm
Width	1250mm
Height	1320mm
Ofcert licence No.	0668040209

H2500T

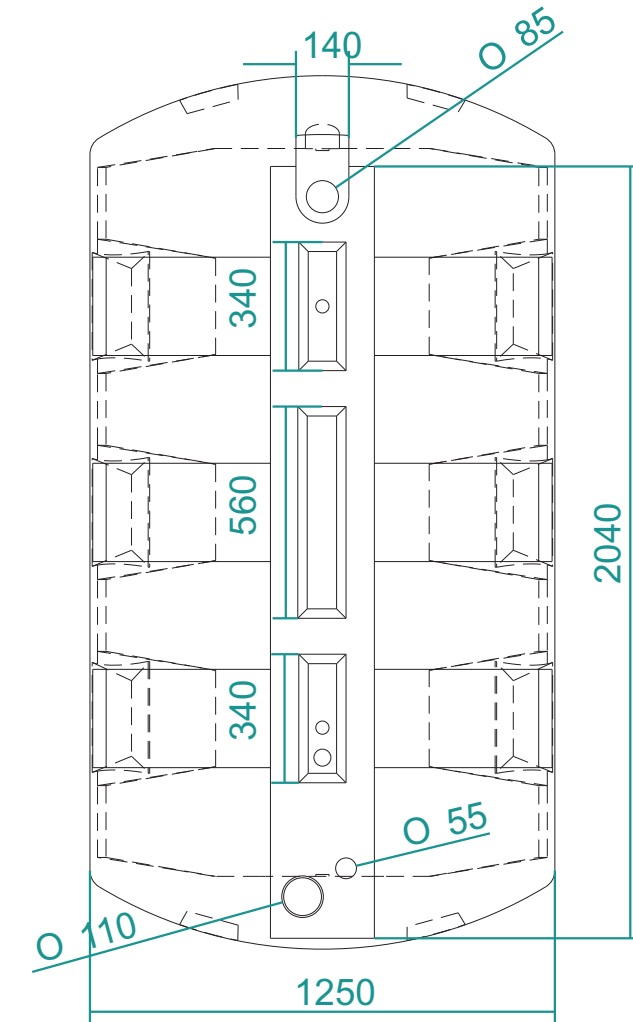
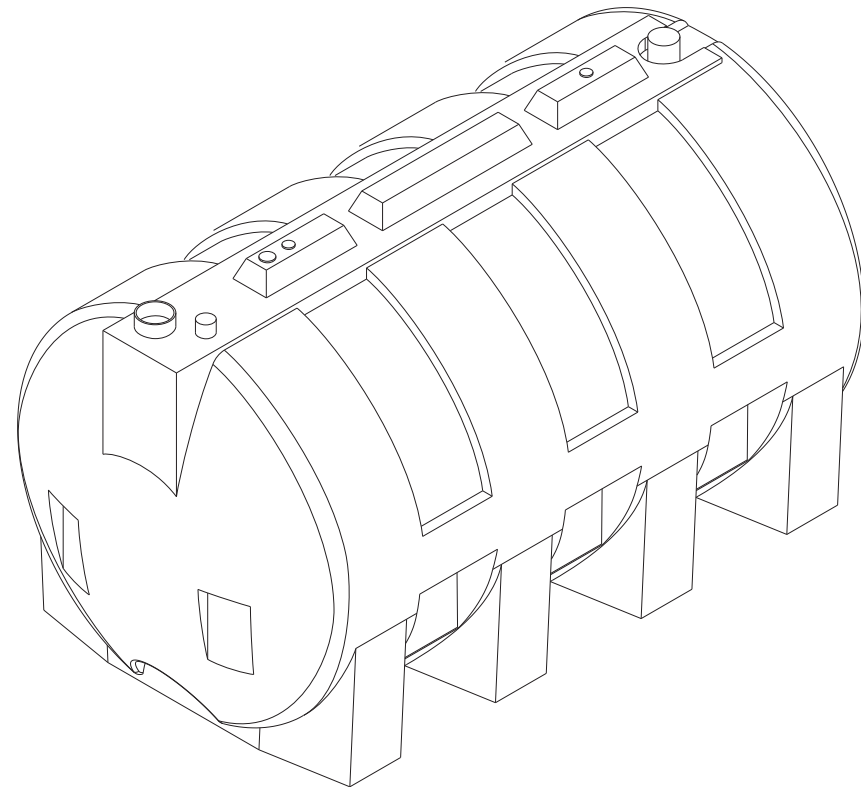
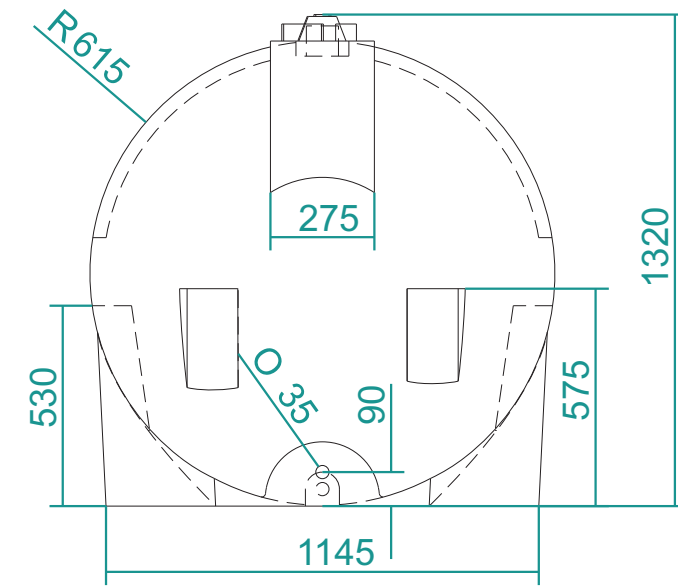
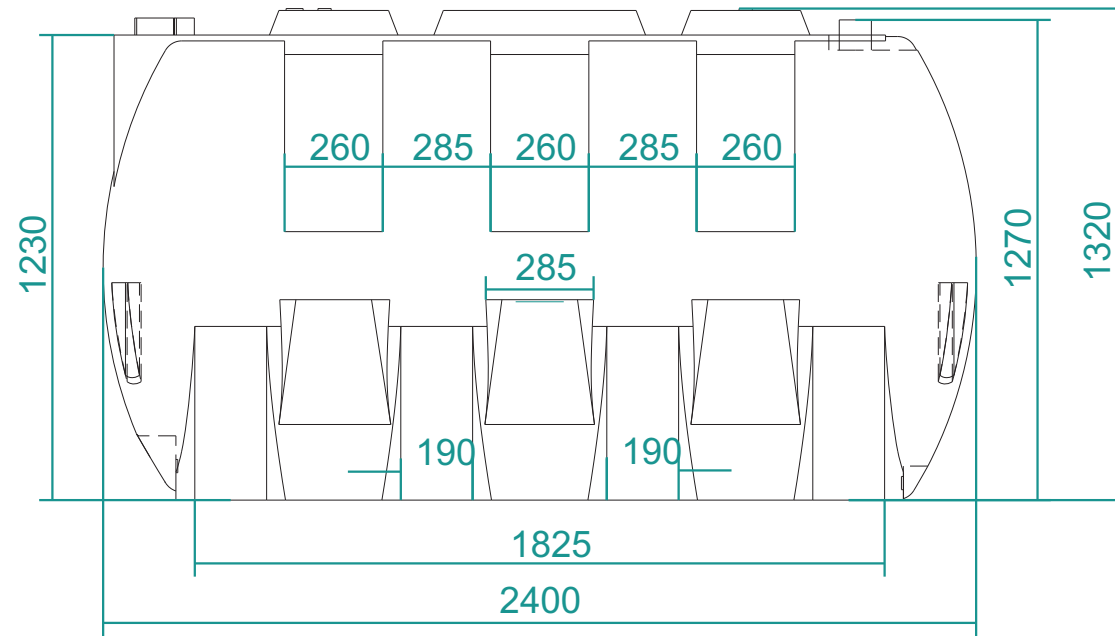

H2500T	No. 1 of 1	3rd Angle Orthographic	scale: 1:20	Design by Inky Design www.inky-design.co.uk
DESO ENGINEERING Telephone - 01984 632026		drawn by: Jonathan Taphouse (BEng)		
		date: 29 - 04 - 2011	ISO	